

# THE TOWNSMAN



Exterior A

2,153 - 3,605 sq. ft.

2 - 5 Bedrooms

2 - 3 Full Baths

2 - 3 Car Garage



Exterior B

**Greg and Jane**



**Exceptional service and experience!**

We have been fortunate enough to build several new homes and this was by far the best experience that we've encountered. We actually debated whether or not we wanted to go through the home building process again or simply purchase a pre-owned home or a finished new home. So pleased we built! Our Weekley team (sales associate, design consultant and builder) was very professional, courteous, attentive, responsive and pro-active from beginning to end. They've all become our adopted kids! Great overall experience!

**David Weekley  
Homes**

# THE TOWNSMAN

2,153 - 3,605 sq. ft. • 2 - 5 Bedrooms • 2 - 3 Full Baths • 2 - 3 Car Garage

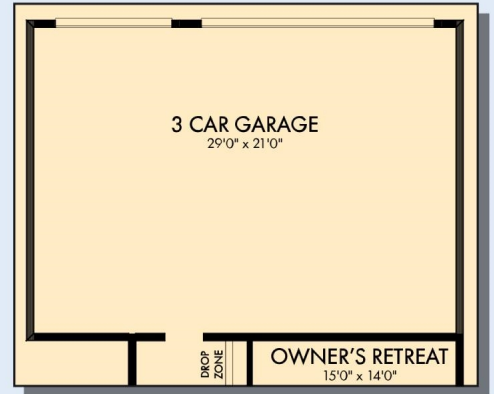

OPTIONAL 3 CAR GARAGE

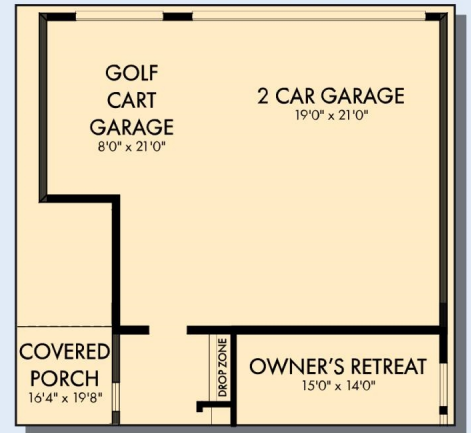

OPTIONAL GOLF CART GARAGE



OPTIONAL SUPER SHOWER AT OWNER'S BATH

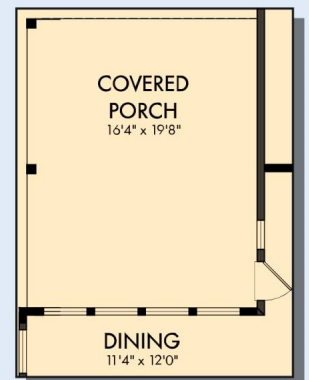

OPTIONAL EXTENDED COVERED PORCH

