

THE ANSON



Exterior A

2,354 - 2,872 sq. ft.

4 Bedrooms

3 Full Baths

2 Car Garage



Exterior B

Meg S.



Truly treated us like family!!!

We enjoyed every part of the home building process. It was amazing! Our builder was always keeping us informed and really went above and beyond to ensure that we love our home. Our warranty rep is outstanding and continues to take care of our every need. I couldn't have asked for a better experience. Our builder and warranty rep continue to be there for us as a family. While our interactions with the DW Family have been highly professional, we are also lucky enough to be able to call them some of our greatest friends! Wouldn't change a thing!

**David Weekley
Homes**

THE ANSON

2,354 - 2,872 sq. ft. • 4 Bedrooms • 3 Full Baths • 2 Car Garage

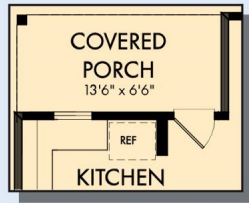

OPTIONAL COVERED PORCH AT KITCHEN

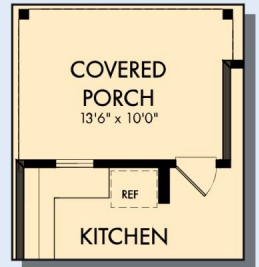

OPTIONAL EXTENDED COVERED PORCH AT KITCHEN

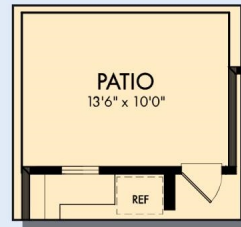

OPTIONAL EXTENDED PATIO AT KITCHEN

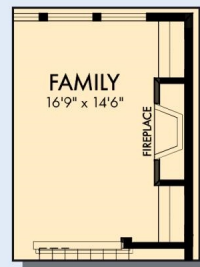

OPTIONAL WALL FIREPLACE WITH CABINETS AT FAMILY

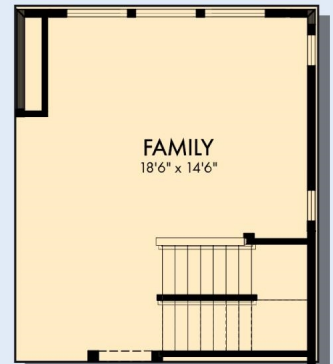

FIRST FLOOR WITH OPTIONAL BASEMENT



THE ANSON



OPTIONAL DROP-IN TUB WITH SEPARATE SHOWER AT OWNER'S BATH

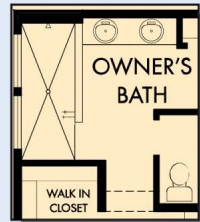

OPTIONAL SUPER SHOWER AT OWNER'S BATH



SECOND FLOOR

For additional options, please visit DavidWeekleyHomes.com

See a David Weekley Homes Sales Consultant for details. Prices, plans, dimensions, features, specifications, materials, and availability of homes or communities are subject to change without notice or obligation. Illustrations are artist's depictions only and may differ from completed improvements. Copyright © 2026 David Weekley Homes - All Rights Reserved. POR, OR

DavidWeekleyHomes.com

