

# THE SHIPMAN



Exterior A

2,208 - 3,942 sq. ft.

3 - 4 Bedrooms

2 - 3 Full Baths

0 - 1 Half Baths

3 Car Garage



Exterior B

**Shane**



**We're living our fairytale thanks to David Weekley**

We can't say enough about the level of quality and care we received while building our home. Our builder was with us every step of the way to make sure our every need and desire was being met! The team truly went above and beyond at every turn to give us the home of our dreams! We will definitely recommend David Weekley to anyone looking to build a new home!

**David Weekley  
Homes**

# THE SHIPMAN

2,208 - 3,942 sq. ft. • 3 - 4 Bedrooms • 2 - 3 Full Baths • 0 - 1 Half Baths • 3 Car Garage



B881 in 4233 IND

For additional options, please visit [DavidWeekleyHomes.com](http://DavidWeekleyHomes.com)

11/11/2025

**DavidWeekleyHomes.com**

# THE SHIPMAN

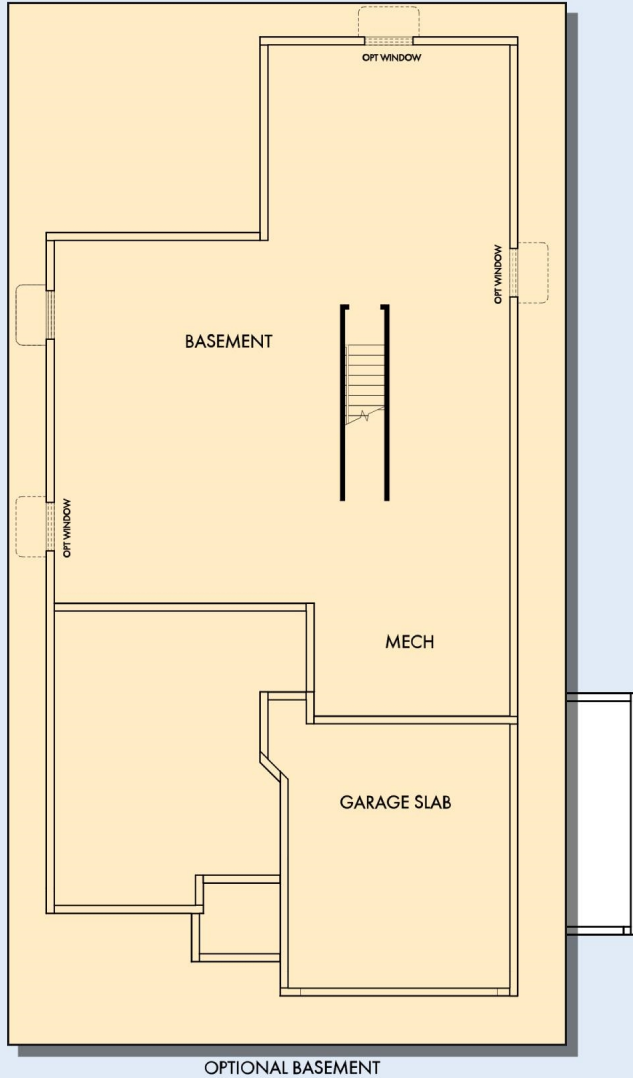

For additional options, please visit [DavidWeekleyHomes.com](http://DavidWeekleyHomes.com)



See a David Weekley Homes Sales Consultant for details. Prices, plans, dimensions, features, specifications, materials, and availability of homes or communities are subject to change without notice or obligation. Illustrations are artist's depictions only and may differ from completed improvements. Copyright © 2025 David Weekley Homes - All Rights Reserved. Indianapolis, IN

**DavidWeekleyHomes.com**