

# THE MAURICE



Exterior E

3,453 - 3,488 sq. ft.

5 Bedrooms

4 Full Baths

3 Car Garage



Exterior F



Exterior G

David Weekley  
Homes

# THE MAURICE

3,453 - 3,488 sq. ft. • 5 Bedrooms • 4 Full Baths • 3 Car Garage

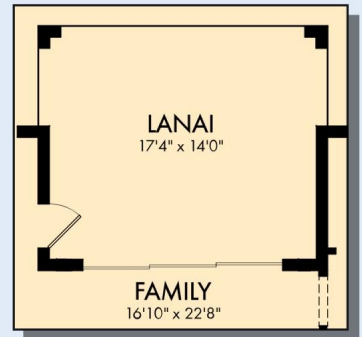

OPTIONAL EXTENDED LANAI WITH SLIDING GLASS DOORS AT FAMILY

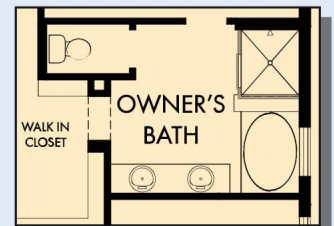

OPTIONAL SLIDE-IN TUB WITH SEPARATE SHOWER AT OWNER'S BATH

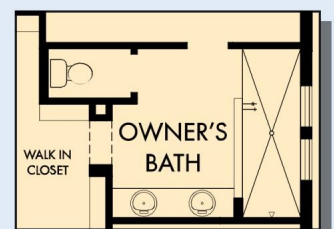

OPTIONAL SUPER SHOWER AT OWNER'S BATH

# THE MAURICE



SECOND FLOOR



OPTIONAL 2ND OWNER'S  
RETREAT WITH 2ND  
OWNER'S BATH AT  
BEDROOMS 4 AND 5

For additional options, please visit [DavidWeekleyHomes.com](http://DavidWeekleyHomes.com)

See a David Weekley Homes Sales Consultant for details. Prices, plans, dimensions, features, specifications, materials, and availability of homes or communities are subject to change without notice or obligation. Illustrations are artist's depictions only and may differ from completed improvements. Copyright © 2026 David Weekley Homes - All Rights Reserved. Tampa, FL

**DavidWeekleyHomes.com**

