

# THE PRYOR



Exterior A

2,490 - 3,363 sq. ft.

3 - 5 Bedrooms

2 - 4 Full Baths

1 Half Bath

3 Car Garage



Exterior B



Exterior C

David Weekley  
Homes

# THE PRYOR

2,490 - 3,363 sq. ft. • 3 - 5 Bedrooms • 2 - 4 Full Baths • 1 Half Bath • 3 Car Garage

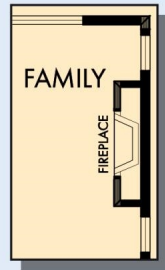

OPTIONAL  
WALL FIREPLACE  
AT FAMILY



A170 in 6026 MSP

For additional options, please visit [DavidWeekleyHomes.com](http://DavidWeekleyHomes.com)

5/16/2025

**DavidWeekleyHomes.com**



# THE PRYOR



OPTIONAL BEDROOM 4



OPTIONAL SLIDE IN TUB  
WITH SEPARATE SHOWER  
AT OWNER'S BATH



OPTIONAL SUPER SHOWER  
AT OWNER'S BATH



OPTIONAL BEDROOM 4  
WITH BATH 3 AT RETREAT



SECOND FLOOR

For additional options, please visit [DavidWeekleyHomes.com](http://DavidWeekleyHomes.com)

DavidWeekleyHomes.com

# THE PRYOR

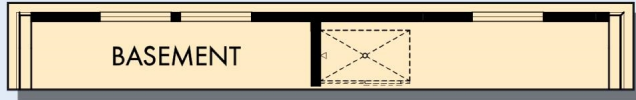

OPTIONAL DAYLIGHT BASEMENT

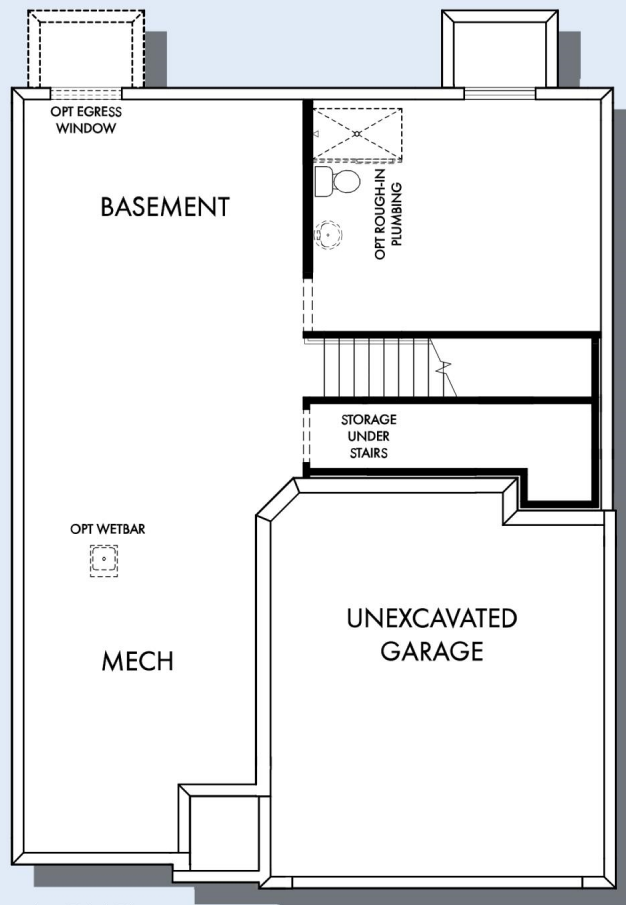

BASEMENT

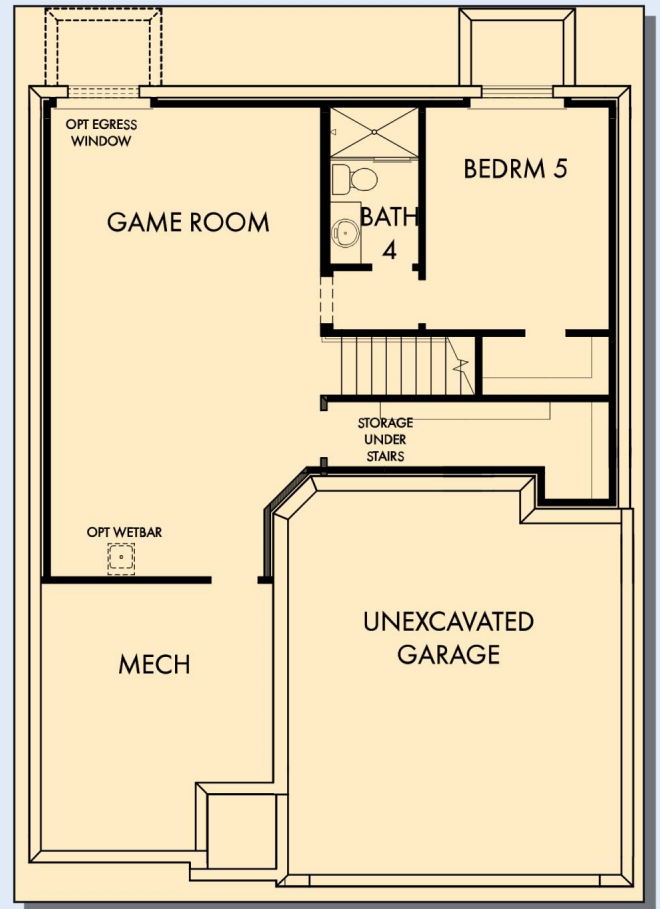

OPTIONAL GAME ROOM WITH BEDROOM 5  
AND BATH 4 AT BASEMENT

For additional options, please visit [DavidWeekleyHomes.com](http://DavidWeekleyHomes.com)

**DavidWeekleyHomes.com**

See a David Weekley Homes Sales Consultant for details. Prices, plans, dimensions, features, specifications, materials, and availability of homes or communities are subject to change without notice or obligation. Illustrations are artist's depictions only and may differ from completed improvements. Copyright © 2025 David Weekley Homes - All Rights Reserved. Minneapolis/St. Paul, MN

