

# THE DYLAN



Exterior A

1,798 sq. ft.

3 - 4 Bedrooms

2 Full Baths

1 Half Bath

0 - 2 Car Garage



Exterior B

**Shane**



**We're living our fairytale thanks to David Weekley**

We can't say enough about the level of quality and care we received while building our home. Our builder was with us every step of the way to make sure our every need and desire was being met! The team truly went above and beyond at every turn to give us the home of our dreams! We will definitely recommend David Weekley to anyone looking to build a new home!

**David Weekley  
Homes**

# THE DYLAN

1,798 sq. ft. • 3 - 4 Bedrooms • 2 Full Baths • 1 Half Bath • 0 - 2 Car Garage

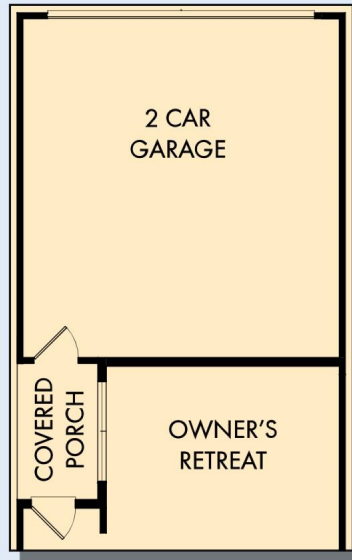

OPTIONAL ATTACHED 2 CAR GARAGE

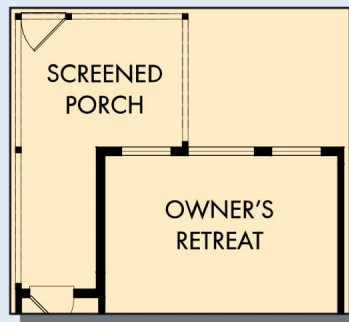

OPTIONAL EXTENDED  
SCREENED PORCH

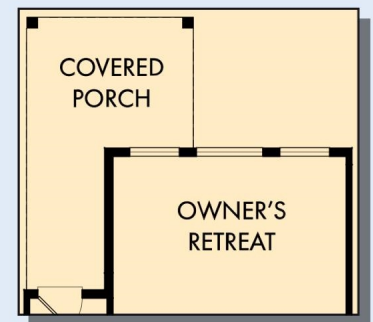

OPTIONAL EXTENDED  
COVERED PORCH

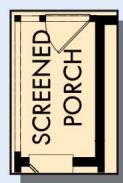

OPTIONAL  
SCREENED  
PORCH

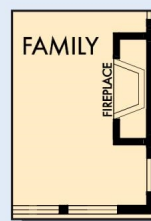

OPTIONAL  
WALL FIREPLACE  
AT FAMILY

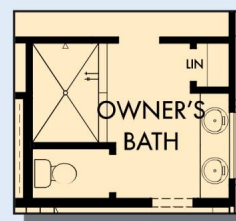

OPTIONAL  
SUPER SHOWER  
AT OWNER'S BATH



OPTIONAL  
FREE STANDING TUB  
WITH SEPARATE SHOWER  
AT OWNER'S BATH



# THE DYLAN

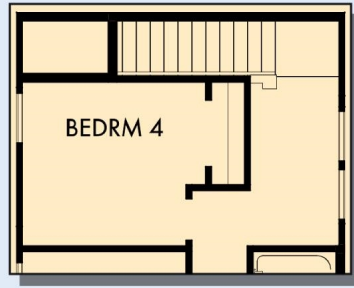

OPTIONAL BEDROOM 4  
AT RETREAT



SECOND FLOOR

For additional options, please visit [DavidWeekleyHomes.com](https://DavidWeekleyHomes.com)



See a David Weekley Homes Sales Consultant for details.  
Prices, plans, dimensions, features, specifications, materials,  
and availability of homes or communities are subject to  
change without notice or obligation. Illustrations are artist's  
depictions only and may differ from completed improvements.  
Copyright © 2025 David Weekley Homes - All Rights Reserved.  
Charleston, SC

## DavidWeekleyHomes.com