

THE ELIAS



Exterior A

1,882 - 2,519 sq. ft.

4 - 5 Bedrooms

2 - 3 Full Baths

1 Half Bath

3 Car Garage



Exterior B

Crystal W.



Welcome Home

My DWHomes experience has been truly 5-stars! From a floorplan concept, reserving a lot filled with dirt, the homebuilding project, to "Welcome Home", the entire process has been amazing. The team provided regular feedback and were always available to address questions and concerns. I was sold on the quality features. The entire team's availability and service has been exceptional before and after closing. Looking forward to enjoying our new home and neighbors for many years to come!

**David Weekley
Homes**

THE ELIAS

1,882 - 2,519 sq. ft. • 4 - 5 Bedrooms • 2 - 3 Full Baths • 1 Half Bath • 3 Car Garage



A402 in 6027 MSP

For additional options, please visit DavidWeekleyHomes.com

5/14/2025

DavidWeekleyHomes.com

THE ELIAS



For additional options, please visit DavidWeekleyHomes.com

DavidWeekleyHomes.com

THE ELIAS

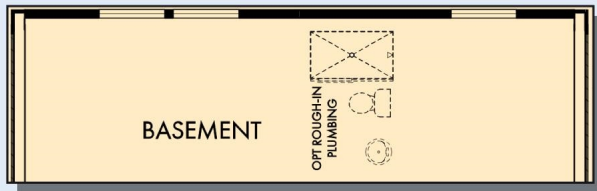

OPTIONAL DAYLIGHT BASEMENT

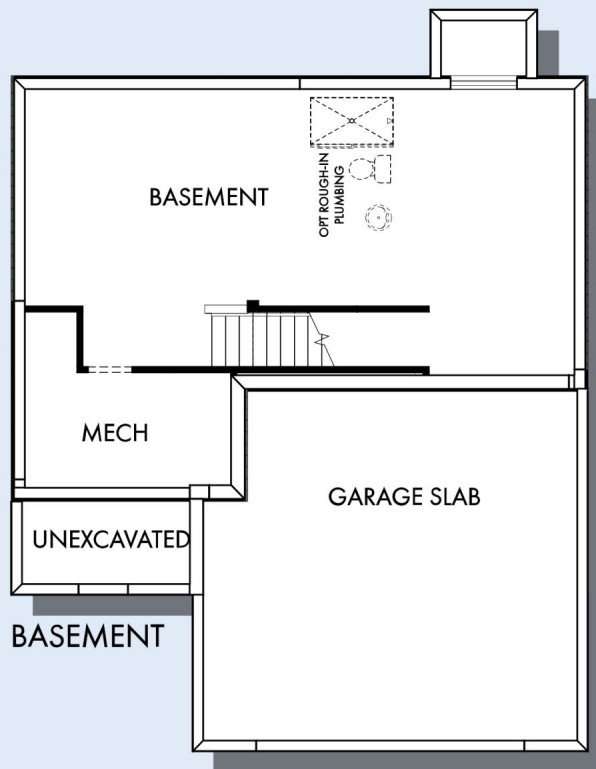

For additional options, please visit DavidWeekleyHomes.com



See a David Weekley Homes Sales Consultant for details. Prices, plans, dimensions, features, specifications, materials, and availability of homes or communities are subject to change without notice or obligation. Illustrations are artist's depictions only and may differ from completed improvements. Copyright © 2025 David Weekley Homes - All Rights Reserved. Minneapolis/St. Paul, MN

DavidWeekleyHomes.com